

THE WOLVERHAMPTON CITY COUNCIL (WEDNESFIELD) (WALDA DRIVE) (20 MPH SPEED LIMIT) ORDER 2025

Wolverhampton City Council in exercise of its powers under Section 84 of the Road Traffic Regulation Act 1984 having given public notice in accordance with sub-section (2) of that section and having consulted with the Chief Officer of Police in accordance with paragraph 20 of part III of Schedule 9 to the Act, hereby make the following Order:-

1. This Order shall come into operation on the ^{30th January 2026} and may be cited as The Wolverhampton City Council (Wednesfield) (Walda Drive) (20 mph Speed Limit) Order 2025
2. No person shall drive any vehicle with a maximum speed exceeding 20 miles per hour on the length of road specified in the below Schedule:

SCHEDULE

1. Walda Drive For the entirety of Walda Drive from junction of Old Fallings Crescent.

THE COMMON SEAL of
Wolverhampton City Council
was hereunto affixed in the
presence of :





*Alexandra Watts (Jan 20, 2026 16:22:46 GMT)

ECWS0046/2026

Authorised Officer Alexandra Watts

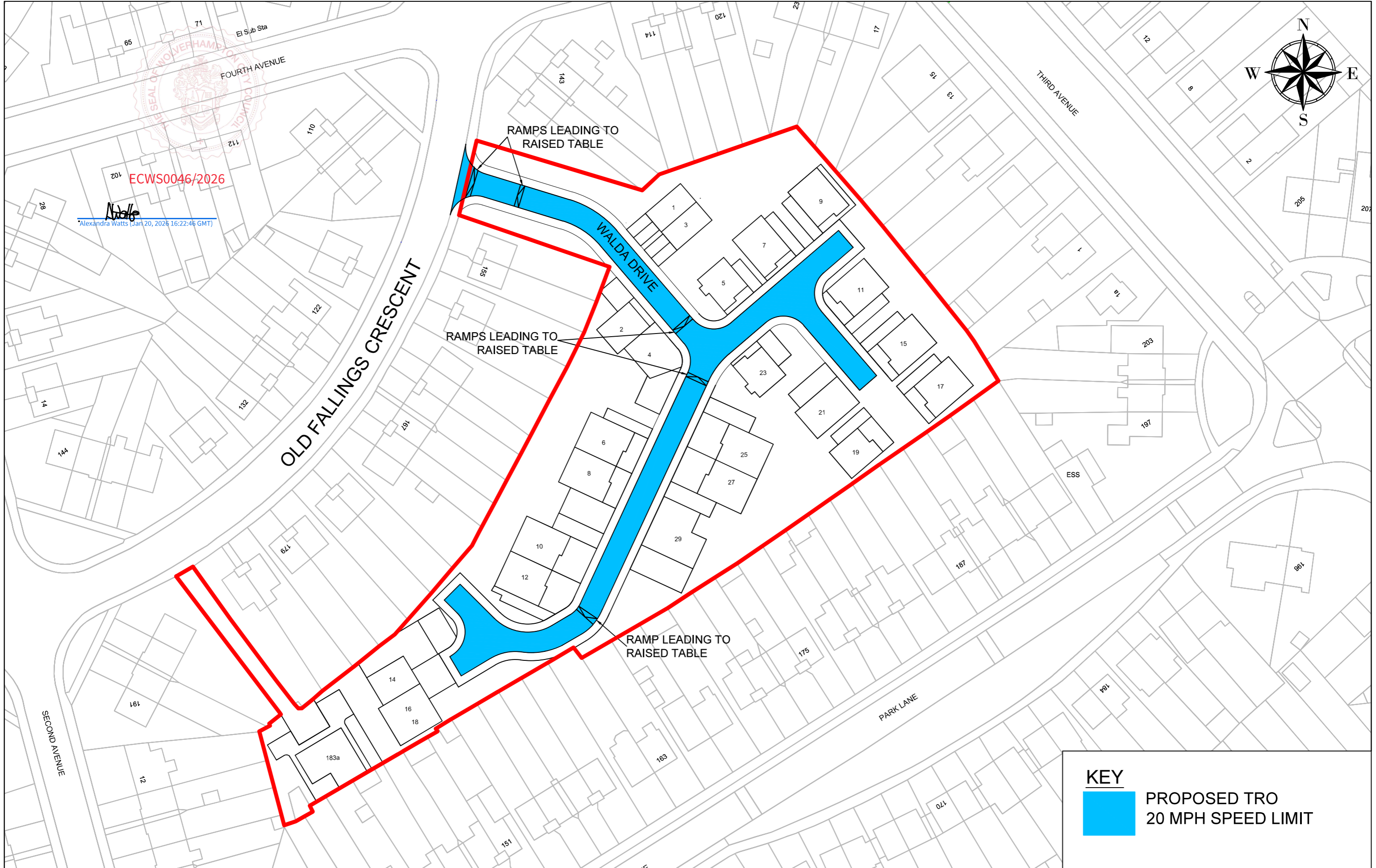
Dated 20th January 2026



ECWS0046/2026

Alexandra Watts (Jan 20, 2026 16:22:46 GMT)

KEY

 PROPOSED TRO
20 MPH SPEED LIMIT

Drawing. No.
T3/2078

Date 20/03/2025

Scale 1:750

**OLD FALLINGS CRESCENT, WALDA DRIVE
PROPOSED 20MPH SPEED LIMIT ORDER PLAN**

City of Wolverhampton Council
Transportation Services,
Place, Civic Centre,
St Peter's Square,
Wolverhampton, WV1 1RP.

**CITY OF
WOLVERHAMPTON
COUNCIL**