

**THE WOLVERHAMPTON CITY COUNCIL (WOLVERHAMPTON
CITY CENTRE METRO EXTENSION) (PROHIBITION AND
RESTRICTION OF WAITING LOADING AND STREET PARKING
PLACES) ORDER 2022**

Wolverhampton City Council in exercise of its powers under Sections 1, 2 and 124(1) (d) and Part IV of Schedule 9 of the Road Traffic Regulation Act 1984 and of all other enabling powers, after consultation with the chief officer of police in accordance with Part III of Schedule 9 to the Act hereby make the following Order:-

1. This Order shall come into operation on the 30th day of December 2022 and may be cited as The Wolverhampton City Council (Wolverhampton City Centre Metro Extension) (Prohibition and Restriction of Waiting and Loading) Order 2022.
2. The Wolverhampton City Council (Wolverhampton City Centre Metro Extension) (Prohibition and Restriction of Waiting and Loading) Order 2022 includes plans (“the Plans”) incorporated in The Wolverhampton City Council (Wolverhampton City Centre Metro Extension) (Prohibition and Restriction of Waiting and Loading) Order 2022 Plan Supplement (“the Plan Supplement”).
3. Save as provided in Article 4 no person shall, except upon the direction or with the permission of a police officer in uniform or of a civil enforcement officer, cause or permit any vehicle to:
 - (i) wait at any time on any day and to load and unload at any time on any day in parts of Bilston Street, Fryer Street, Lichfield Street and St Georges Parade as specified on the Plan Supplement.

4. Nothing in Article 3 shall render it unlawful to cause or permit any vehicle to wait on the roads specified therein for so long as may be necessary to enable –

(a) a person to board or alight from the vehicle;

(b) the vehicle, if it cannot be conveniently used for such purposes in any other road, to be used in connection with any of the following operations, namely –

(i) building, industrial or demolition operations;

(ii) the removal of any obstruction to traffic;

(iii) the maintenance, improvement or reconstruction of the said roads;

(iv) the laying, erection, alteration, or repair in or on land adjacent to the said lengths of roads or any sewer or of any main, pipe or apparatus for the supply of gas, water or electricity or of any electronic communications apparatus as defined in section 151 of the Communications Act 2003; and

(v) the vehicle, if it cannot be conveniently used for such purpose in any other road, to be used in the service of a local authority or its contractors in pursuance of that authority's statutory powers or duties;

(c) the vehicle, in the service of the Royal Mail company (as defined in section 2(6) of the Postal Services Act 2011), or other universal provider to be used for the purpose of delivering and/or collecting mail.

5. Existing traffic regulation orders to Bilston Street, Fryer Street, Lichfield Street and St Georges Parade are hereby revoked to the extent necessary to facilitate the provisions of this Order.

THE COMMON SEAL OF Wolverhampton City
Council was hereunto affixed in the
presence of:



Authorised Officer

Dated: 16th December 2022



646/2022

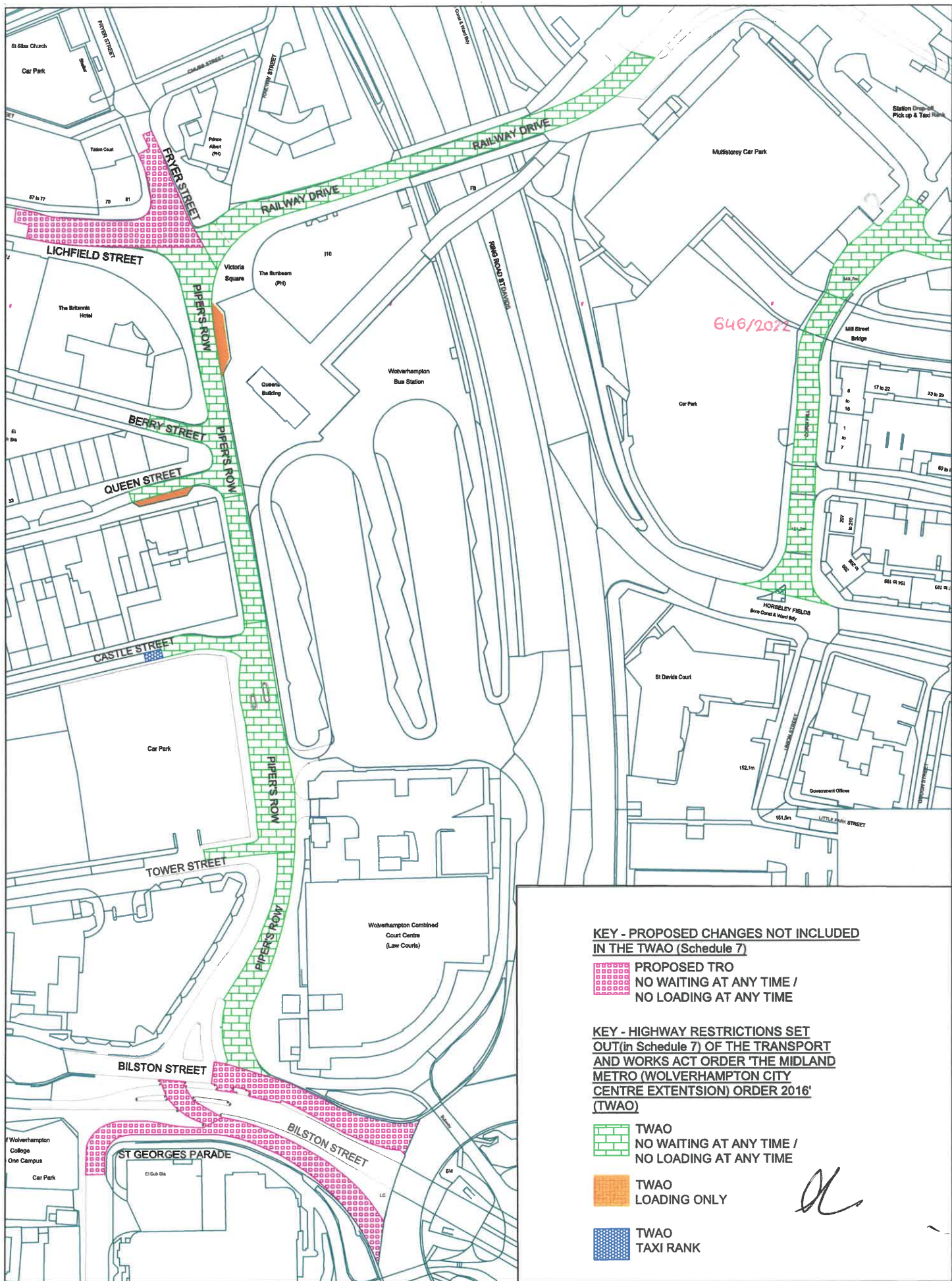

KEY - PROPOSED CHANGES NOT INCLUDED IN THE TWAO (Schedule 7)

 PROPOSED TRO
NO WAITING AT ANY TIME /
NO LOADING AT ANY TIME

KEY - HIGHWAY RESTRICTIONS SET OUT (in Schedule 7) OF THE TRANSPORT AND WORKS ACT ORDER 'THE MIDLAND METRO (WOLVERHAMPTON CITY CENTRE EXTENTSION) ORDER 2016' (TWAO)

 TWAO
NO WAITING AT ANY TIME /
NO LOADING AT ANY TIME

 TWAO
LOADING ONLY

 TWAO
TAXI RANK

Handwritten signature

Drawing No.

T3/1619 - 01A

Date 11/05/2022

Scale 1:1250

THE WOLVERHAMPTON CITY COUNCIL
(CITY CENTRE-METRO EXTENSION) PROHIBITION AND
RESTRICTION OF WAITING AND LOADING ORDER 2022

City of Wolverhampton Council
Transportation Services,
Place, Civic Centre,
St Peter's Square,
Wolverhampton, WV1 1RP.

**CITY OF
WOLVERHAMPTON
COUNCIL**