

THE WOLVERHAMPTON CITY COUNCIL (WEDNESFIELD)
(PROHIBITION AND RESTRICTION OF WAITING AND STREET PARKING
PLACES) (AMENDMENT NO 6) ORDER 2021

Wolverhampton City Council in exercise of its powers under Sections 1, 2 and 124(1) (d) of the Road Traffic Regulation Act 1984 and of all other enabling powers, after consultation with the chief officer of police in accordance with Part III of Schedule 9 to the Act hereby make the following Order:-

1. This Order shall come into operation on the 16 day of September and may be cited as The Wolverhampton City Council (Wednesfield) (Prohibition and Restriction of Waiting and Street Parking Places) (Amendment No 6) Order 2021.

2. The Wolverhampton City Council (Wednesfield) (Prohibition and Restriction of Waiting and Street Parking Places) (Amendment No 6) Order 2021 includes plans ("the Plans") incorporated in The Wolverhampton City Council (Wednesfield) (Prohibition and Restriction of Waiting and Street Parking Places) (Amendment No 6) Order 2021 Plan Supplement ("the Plan Supplement").

3. Save as provided in Article 4 no person shall, except upon the direction or with the permission of a police officer in uniform or of a civil enforcement officer, cause or permit any vehicle to:
 - (i) wait at any time in parts of High Street and Church Street as specified on the Plan;

 - (ii) wait for a period longer than 1 hour with no return within 2 hours Monday to Saturday between 8am and 6:30pm in parts of High Street and Church Street as specified on the Plan;

(iii) wait for a period longer than 3 hours with no return within 2 hours Monday to Saturday between 8am and 6:30pm in parts of Nicholls Fold and Woodhouse Fold as specified on the Plan;

(iv) wait in a disabled person's parking place unless:

(a) there is displayed on that vehicle in the relevant position a valid disabled person's badge for a period longer than 3 hours with no return within 1 hour in parts of High Street and Nicholls Fold as specified on the Plan; and

(b) provided also that the vehicle immediately before or after the act of parking in the disabled person's parking place has been or is about to be driven or used by the person to whom the valid disabled person's badge has been issued or as the case may be, used for the carrying of disabled person(s) as passengers(s);

(v) wait Monday to Saturday between 2pm to 10.00am unless such waiting is necessary to enable goods to be loaded or unloaded from the vehicle in connection with adjoining trade or business premises in parts of High Street and Church Street as specified on the Plan;

(vi) wait at any time on any day or to load and unload at any time on any day in parts of Woodhouse Fold, Nicholls Fold, Alfred Squire Road, High Street, Church Street and Graiseley Lane as specified on the Plan.

4. Nothing in Article 3 shall render it unlawful to cause or permit any vehicle to wait on the roads specified therein for so long as may be necessary to enable –

(a) a person to board or alight from the vehicle;

- (b) the vehicle, if it cannot be conveniently used for such purposes in any other road, to be used in connection with any of the following operations, namely –
 - (i) building, industrial or demolition operations;
 - (ii) the removal of any obstruction to traffic;
 - (iii) the maintenance, improvement or reconstruction of the said roads;
 - (iv) the laying, erection, alteration or repair in or on land adjacent to the said lengths of roads or any sewer or of any main, pipe or apparatus for the supply of gas, water or electricity or of any telecommunications apparatus as defined in the Telecommunications Act 1984; and
 - (v) the vehicle, if it cannot be conveniently used for such purpose in any other road, to be used in the service of a local authority or its contractors in pursuance of that authority's statutory powers or duties;
 - (c) the vehicle, in the service of Royal Mail or other universal provider (as defined in Section 4(3) and (4) of the Postal Services Act 2000), to be used for the purpose of delivering and/or collecting mail.
5. Existing Traffic Regulation Orders are hereby varied or revoked to the extent insofar as is necessary to facilitate the provisions of this Order.

THE COMMON SEAL OF
WOLVERHAMPTON CITY COUNCIL
was hereunto affixed in
the presence of:

Alatto

Authorised Officer

Dated *13 September 2021*



21/28/2021

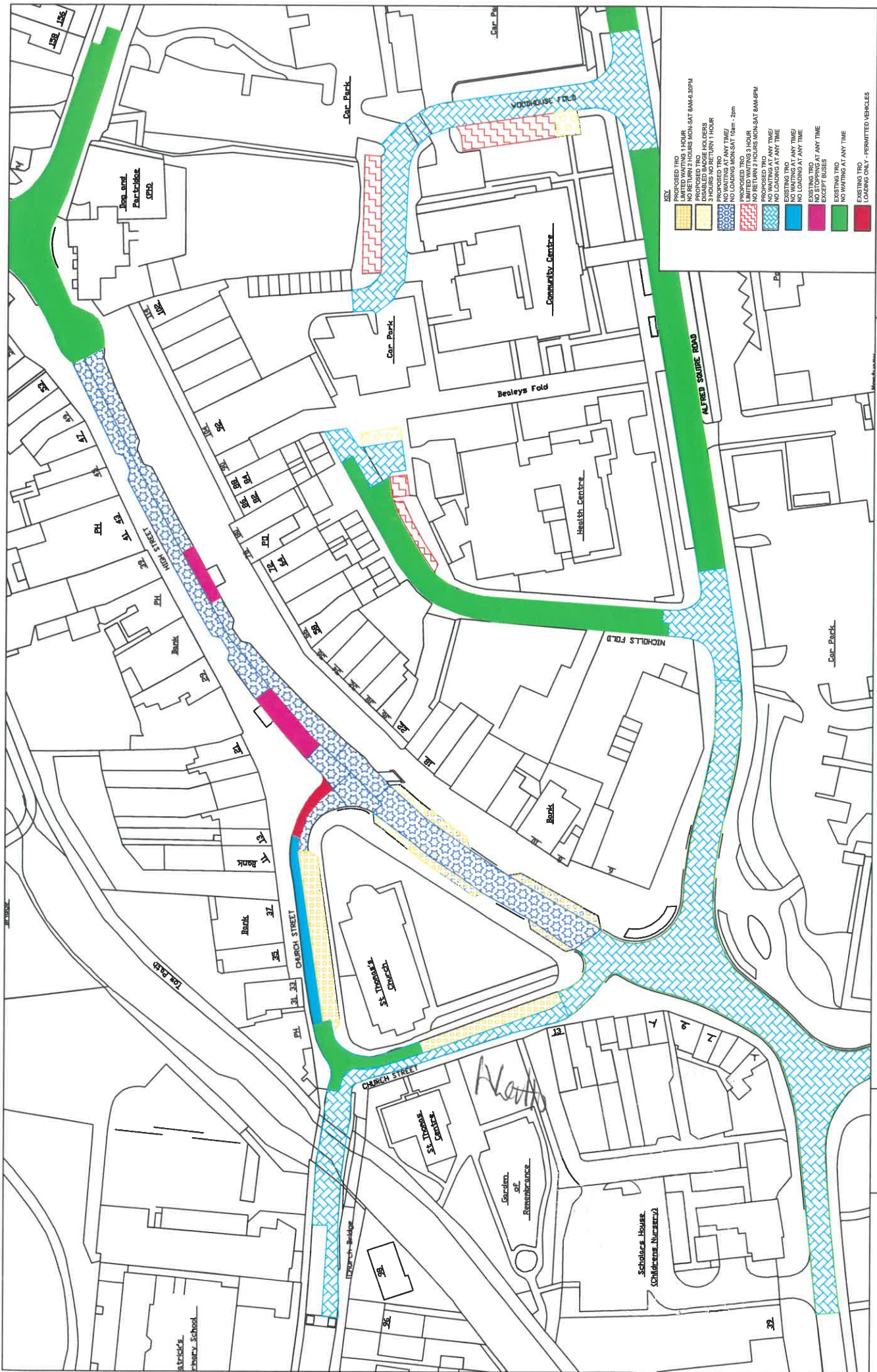

- KEY**
- PROPOSED TRO 1 HOUR
 - NO RETURN 2 HOURS MON-SAT 8AM-6.30PM
 - PROPOSED TRO 3 HOURS NO RETURN
 - PROPOSED TRO 3 HOURS NO RETURN 1 HOUR
 - PROPOSED TRO NO WAITING AT ANY TIME
 - NO LOADING MON-SAT 10am - 2pm
 - PROPOSED TRO NO RETURN 2 HOURS MON-SAT 8AM-6PM
 - PROPOSED TRO NO RETURN 2 HOURS MON-SAT 8AM-6PM
 - NO WAITING AT ANY TIME/ EXCEPT BUSES
 - EXISTING TRO NO WAITING AT ANY TIME/ EXCEPT BUSES
 - EXISTING TRO NO LOADING AT ANY TIME
 - EXISTING TRO NO STOPPING AT ANY TIME EXCEPT BUSES
 - EXISTING TRO NO WAITING AT ANY TIME
 - EXISTING TRO LOADING ONLY - PERMITTED VEHICLES

CITY OF WOLVERHAMPTON COUNCIL

City of Wolverhampton Council
 Transportation Services,
 Place, Civic Centre,
 St Peter's Square,
 Wolverhampton, WV1 1RP.

**WEDNESFIELD HIGH STREET AREA
 ON STREET WAITING & LOADING PROPOSALS**

Drawing No. **T3/ 1339 -01A**

Date 23/02/2021

Scale NTS