

**THE WOLVERHAMPTON CITY COUNCIL (PENN) (PROHIBITION
AND RESTRICTION OF WAITING AND STREET PARKING
PLACES) (AMENDMENT NO 1) ORDER 2022**

Wolverhampton City Council in exercise of its powers under Sections 1, 2 and 124(1) (d) and Part IV of Schedule 9 of the Road Traffic Regulation Act 1984 and of all other enabling powers, after consultation with the chief officer of police in accordance with Part III of Schedule 9 to the Act hereby make the following Order:-

1. This Order shall come into operation on the *2* day of *September 2022* and may be cited as The Wolverhampton City Council (Penn) (Prohibition and Restriction of Waiting and Street Parking Places) (Amendment No 1) Order 2022.
2. The Wolverhampton City Council (Penn) (Prohibition and Restriction of Waiting and Street Parking Places) (Amendment No 1) Order 2022 includes plans (“the Plans”) incorporated in The Wolverhampton City Council (Penn) (Prohibition and Restriction of Waiting and Street Parking Places) (Amendment No 1) Order 2022 Plan Supplement (“the Plan Supplement”)
3. Save as provided in Article 4 no person shall, except upon the direction or with the permission of a police officer in uniform or of a civil enforcement officer, cause or permit any vehicle to:
 - (i) wait at any time on any day and to load and unload on any day at any time in parts of Compton Road, Marchant Road, Westland Road, Westland Avenue, Merridale Lane, Merridale Crescent and Merridale Avenue;
 - (ii) wait between 8.00am to 9.30am and 2.30pm to 6.30pm Monday to Friday and to load and unload between 8.00am to

9.30am and 2.30pm to 6.30pm Monday to Friday in parts of Compton Road;

- (iii) wait between 8.00am to 9.30am and 2.30pm to 4.30pm Monday to Friday and to load and unload between 8.00am to 9.30am and 2.30pm to 4.30pm Monday to Friday in parts of Compton Road and Westland Road; and
- (iv) wait at any time on any day and to load and unload between 8.00am to 9.30am and 2.30pm to 4.30pm Monday to Friday in parts of Merridale Lane;

as specified on the Plan.

- 4. Nothing in Article 3 shall render it unlawful to cause or permit any vehicle to wait on the roads specified therein for so long as may be necessary to enable –
 - (a) a person to board or alight from the vehicle;
 - (b) the vehicle, if it cannot be conveniently used for such purposes in any other road, to be used in connection with any of the following operations, namely –
 - (i) building, industrial or demolition operations;
 - (ii) the removal of any obstruction to traffic;
 - (iii) the maintenance, improvement or reconstruction of the said roads;
 - (iv) the laying, erection, alteration or repair in or on land adjacent to the said lengths of roads or any sewer or of any main, pipe or apparatus for the supply of gas, water

or electricity or of any electronic communications apparatus as defined in section 151 of the Communications Act 2003; and

(v) the vehicle, if it cannot be conveniently used for such purpose in any other road, to be used in the service of a local authority or its contractors in pursuance of that authority's statutory powers or duties;

(c) the vehicle, in the service of the Royal Mail company (as defined in section 2(6) of the Postal Services Act 2011), or other universal provider to be used for the purpose of delivering and/or collecting mail.

5. Existing Traffic Regulation Orders are hereby varied or revoked to the extent insofar as is necessary to facilitate the provisions of this Order.

THE COMMON SEAL OF Wolverhampton City Council was hereunto affixed in the presence of:

Shatts

Authorised Officer

Dated: *31 August 2022*



427/2022

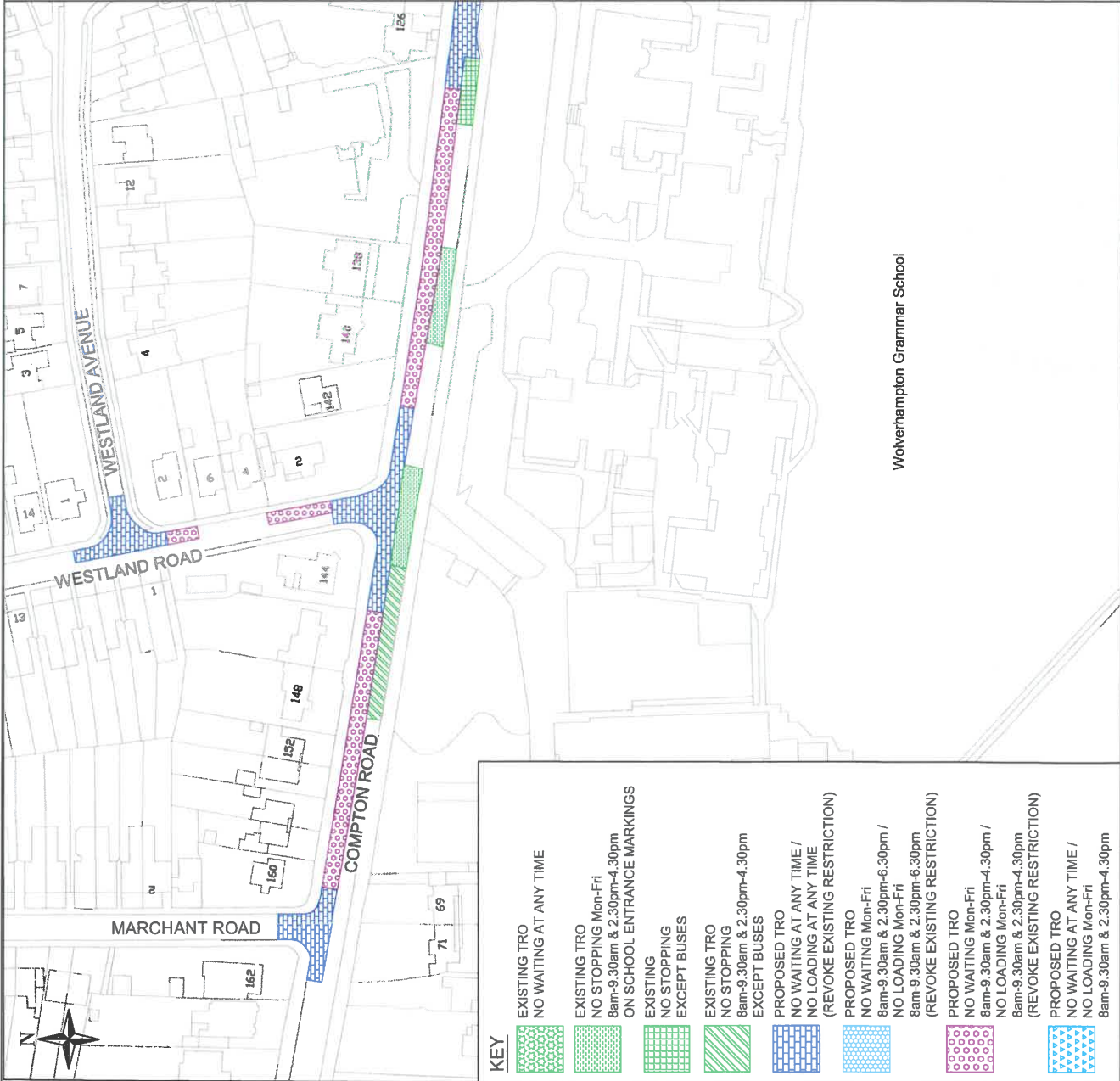
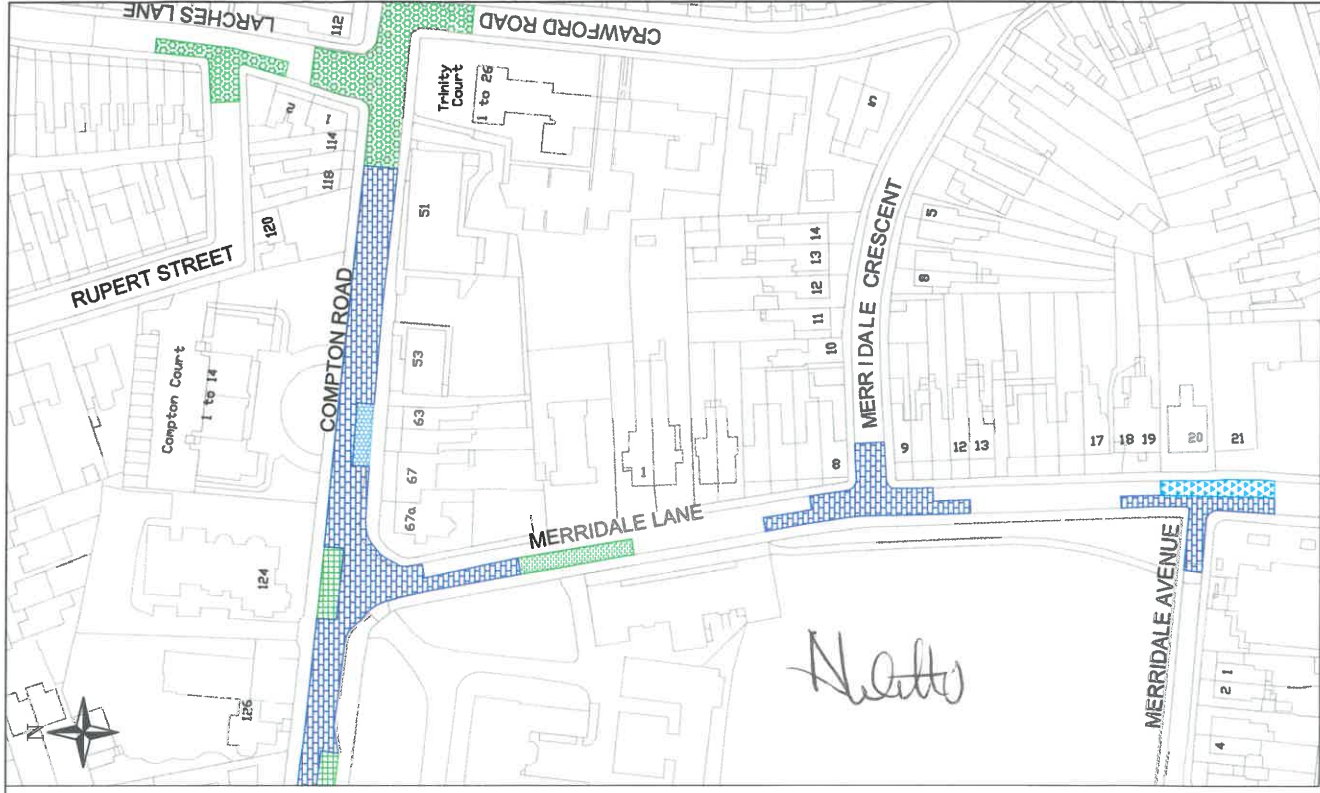

KEY	DESCRIPTION
	EXISTING TRO NO WAITING AT ANY TIME
	EXISTING TRO NO STOPPING Mon-Fri 8am-9.30am & 2.30pm-4.30pm ON SCHOOL ENTRANCE MARKINGS
	EXISTING NO STOPPING EXCEPT BUSES
	EXISTING TRO NO STOPPING 8am-9.30am & 2.30pm-4.30pm EXCEPT BUSES
	PROPOSED TRO NO WAITING AT ANY TIME / NO LOADING AT ANY TIME (REVOKE EXISTING RESTRICTION)
	PROPOSED TRO NO WAITING Mon-Fri 8am-9.30am & 2.30pm-6.30pm / NO LOADING Mon-Fri 8am-9.30am & 2.30pm-6.30pm (REVOKE EXISTING RESTRICTION)
	PROPOSED TRO NO WAITING Mon-Fri 8am-9.30am & 2.30pm-4.30pm / NO LOADING Mon-Fri 8am-9.30am & 2.30pm-4.30pm (REVOKE EXISTING RESTRICTION)
	PROPOSED TRO NO WAITING AT ANY TIME / NO LOADING Mon-Fri 8am-9.30am & 2.30pm-4.30pm (REVOKE EXISTING RESTRICTION)

City of Wolverhampton Council
Transportation Services,
Place, Civic Centre,
St Peter's Square,
Wolverhampton, WV1 1RP.

**CITY OF
WOLVERHAMPTON
COUNCIL**

COMPTON ROAD, WESTLAND ROAD, WESTLAND AVENUE,
MERRIDALE LANE, MERRIDALE CRESCENT, MARCHANT ROAD
PROPOSED WAITING AND LOADING RESTRICTIONS PLAN

T3/1096D

Drawing No. **T3/1096D**

Date 27/06/2022
Scale 1:1250